

RED ARROWS = Walk-through direction (bedroom ↔ closets ↔ bathroom)

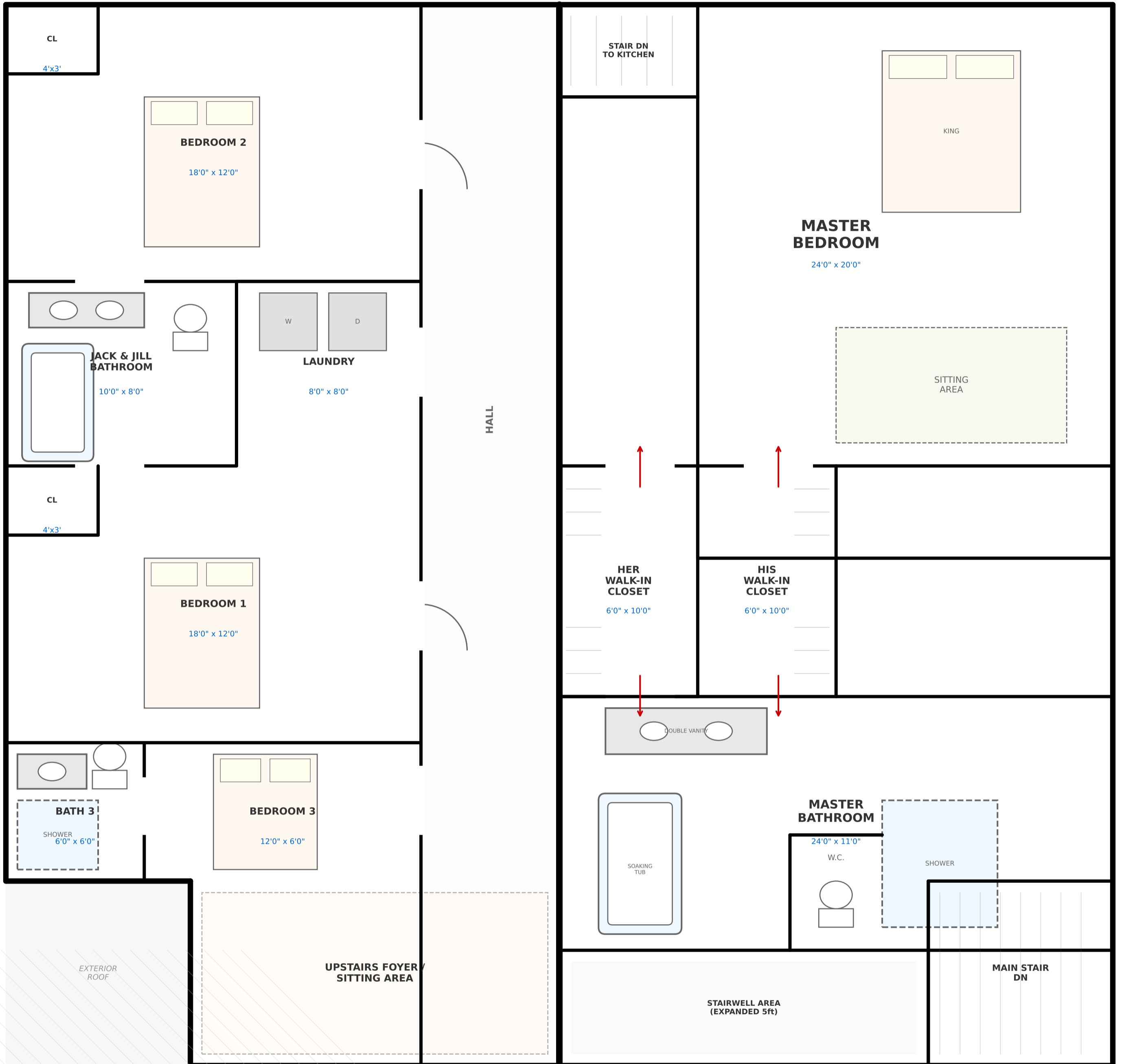

← OFFICE SIDE (3 BEDROOMS) →

← DORMS SIDE (MASTER SUITE) →



▲ CENTRAL LOAD-BEARING WALL ▲

PROPOSED SECOND FLOOR PLAN — V3

FIREHOUSE — 18 NEW ST, CROSSWICKS, NJ 08515

Block 300, Lot 12 | Revised Layout | March 28, 2026

LEGEND:

— Load-bearing wall

— Exterior wall

— Interior wall

