



<-- OFFICE SIDE (3 BEDROOMS) -->

<-- DORMS SIDE (MASTER SUITE) -->

26'-0"

30'-0"



" INTERIOR DIVIDING WALL (not load-bearing) "

56'-0"

~ CENTRAL LOAD-BEARING WALL ~

LEGEND:

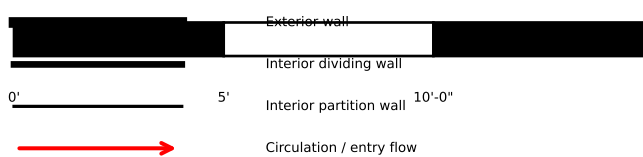

PROPOSED SECOND FLOOR PLAN — V13

FIREHOUSE — 18 NEW ST, CROSSWICKS, NJ 08515

Block 300, Lot 12 | Old School Firehouse LLC

Scale: 1/4" = 1'-0" | Date: March 29, 2026

PROPOSED — NOT FOR CONSTRUCTION

Drawing A-201 | Sheet 1 of 1